

# High performance inductive PD sensor

## HFCT 70mm

Techimp HFCT 70mm is an inductive sensor for Partial Discharge detection. It is suitable for online/offline PD tests on many electrical systems such as MV/HV cables, transformers, rotating machines and others.

Techimp HFCT 70mm can be easily installed on the ground connection of the electrical system under test having a ground cable or connector maximum diameter of about 70mm.

Techimp HFCT 70mm can be directly connected to any Techimp PD acquisition unit by means of a 50Ω coaxial cable.

The arrow on the enclosure indicates the polarity of the output voltage ( $V_{out}$ ) in relation to the input current ( $I_{in}$ ) direction. The sensor should be installed having the arrow towards the ground so that the detected voltage signal ( $V_{out}$ ) has the same phase as the input current ( $I_{in}$ ).

### Benefits

- Maintenance free
- High sensitivity and reliability
- Robust and easy to use
- Safety

### Specifications

Bandwidth  
Max Sensitivity ( $V_{out} / I_{in}$  @5MHz)  
Load Impedance  
Hole dimension  
Operating temperature

1MHz ÷ 80MHz  
12mV/mA  
50Ω  
Φ 70mm  
-20°C +70°C



# HFCT 70mm

## Frequency Response

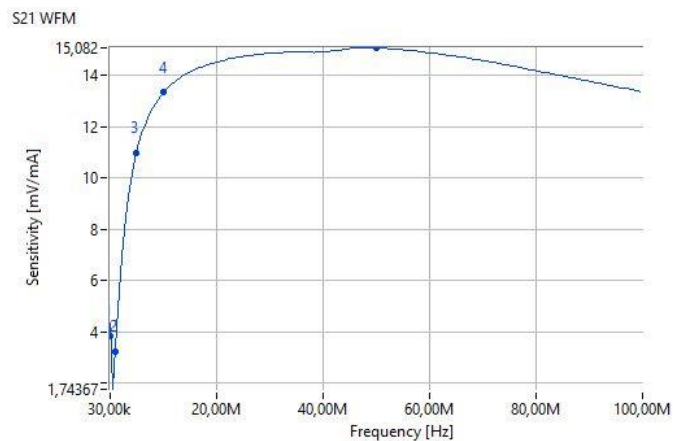

## Mechanical Specification DUCT VERSION

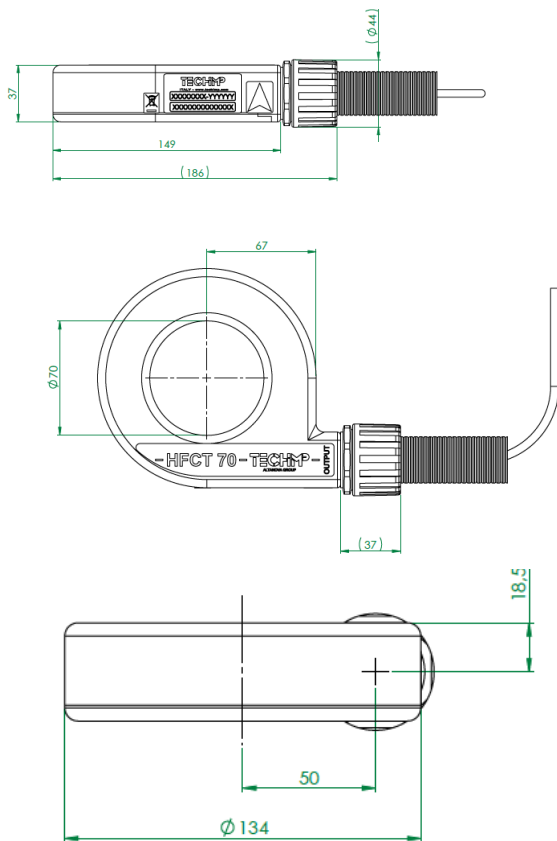

## Mechanical Specification BNC VERSION

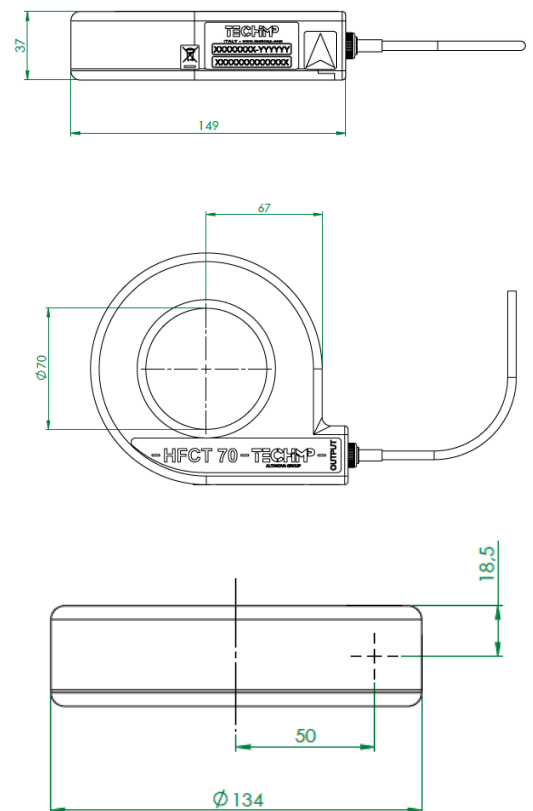

Suitable For

HVAC CABLE	MVAC CABLE	HVDC CABLE	MOTOR	GENERATOR	PWM VSD	GIS GIL GIB	SWITCH BOARDS	OUTDO OR INSULATOR	HV TRAFO	MV TRAFO	TA/TV
------------	------------	------------	-------	-----------	---------	-------------	---------------	--------------------	----------	----------	-------

Several different sensors are available, fully compatible with Techimp Global Diagnostic platform. They can be freely combined at customer needs provided they can be applied for the specific application.

**ALTANOVA**  
GROUP  
[www.altanova-group.com](http://www.altanova-group.com)

**TECHIMP**  
TECHIMP - ALTANOVA GROUP  
Via Toscana 11,  
40069 Zola Predosa (Bo) - Italy  
T +39 051 199 86 050  
Email [sales@altanova-group.com](mailto:sales@altanova-group.com)

**isa**  
ISA - ALTANOVA GROUP  
Via Prati Bassi 22,  
21020 Taino (Va) - Italy  
T +39 0331 95 60 81  
Email [isa@altanova-group.com](mailto:isa@altanova-group.com)

**intelliSAW**  
intelliSAW - ALTANOVA GROUP  
100 Burrill Rd  
Andover, MA 01810, USA  
T +1 978-409-1534  
Email [contact@intellisaw.com](mailto:contact@intellisaw.com)